



This map is reproduced from Ordnance Survey material with the permission of Ordnance Survey on behalf of the Controller of Her Majesty's Stationery Office. © Crown copyright. Unauthorised reproduction infringes Crown copyright and may lead to prosecution or civil proceedings.
Stockton-on-Tees Borough Council 100023297 2011

This drawing should not be scaled. All dimensions must be checked on site and contractor to report any omissions or errors to the contract administrator

NOTES

KEY

-  Current long stay car parking on street
-  Long stay car parks
-  Current 2 hour disc zone

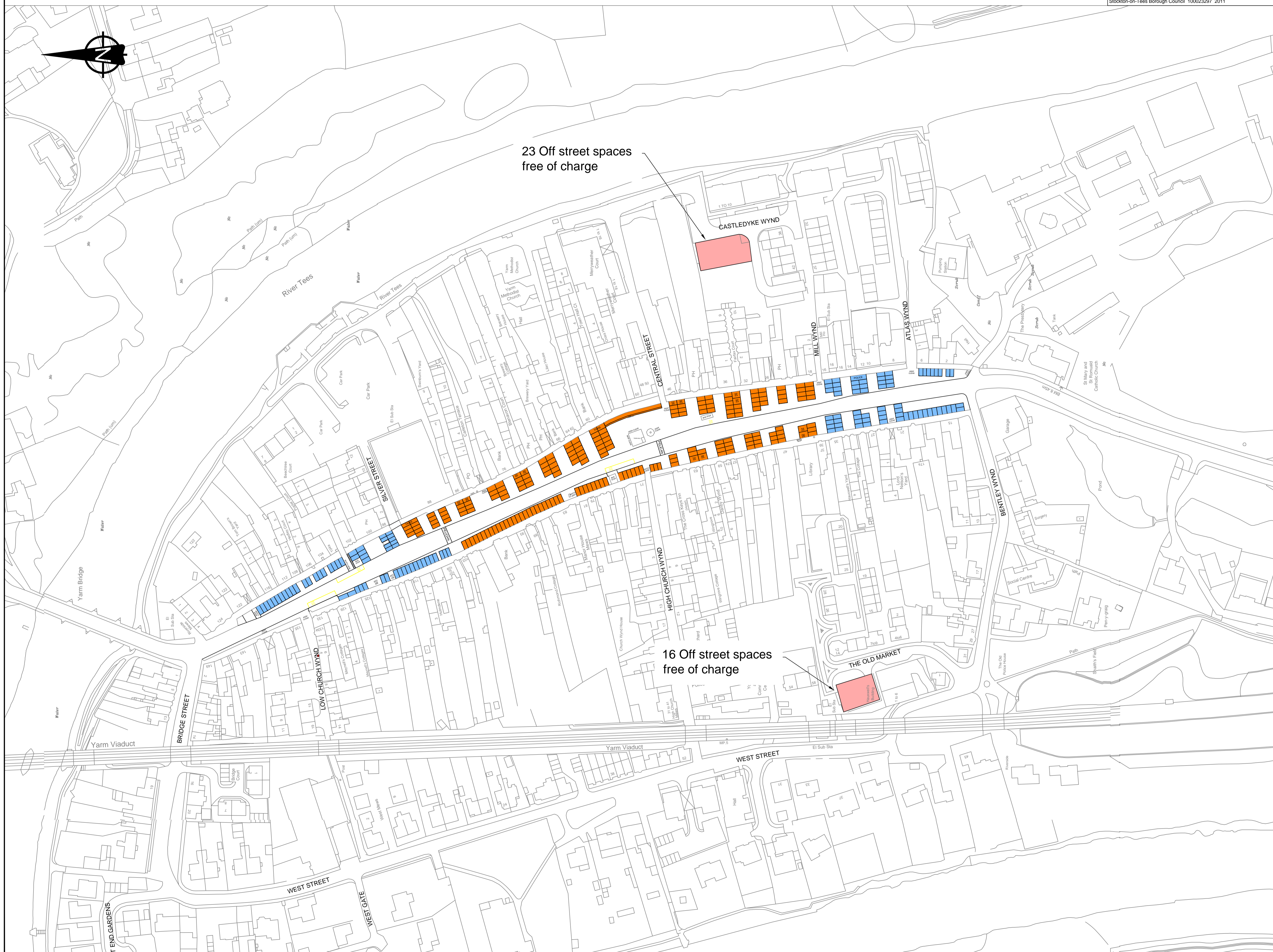

Rev	Description	Dm	Chk	Date

Drawing Status: PRELIMINARY APPROVAL
 INFORMATION TENDER CONSTRUCTION



Development & Neighbourhood Services
 Head of Technical Services Richard McGuckin B.Eng., C.Eng., M.I.C.E.
 P.O. Box 229, Kingsway House, West Precinct, Billingham, TS23 2YL.
 Telephone (01642) 393939. E-mail: technicalservices@stockton.gov.uk

Project: **YARM HIGH STREET**

Content: **EXISTING PARKING LAYOUT**

Date	DEC '12	Dwg No.	TM5/762
Drawn	AB	Checked	AT
		Scales @ A1	N.T.S
			Rev